

DECLARATION OF PERFORMANCE

1. Type, batch or serial number:

SDS with Washer, St. Sheets to Wood by RAL Kamfix
SDS with Washer, St. Sheets to Wood, Zn, Kamfix

2. Intended use or uses:

For fastening metal sheets with a thickness of up to 2.5 mm to wooden bases.

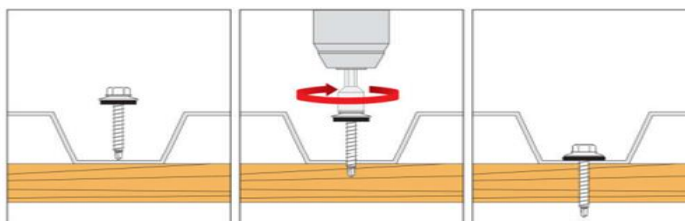

3. Name, registered trade name or registered trademark and contact address.

KAM-04 Ltd.

176, Brezovsko Shousse str., 4003 Plovdiv, Bulgaria

Trade mark

kamfix

4. System or systems for assessment and verification of constancy of performance.

System 2+

5. Declared performance indicators:

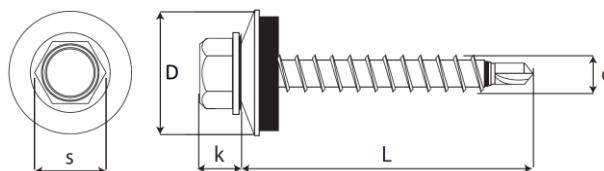

SDS with Washer, St. Sheets to Wood by RAL Kamfix
SDS with Washer, St. Sheets to Wood/ Zn, Kamfix

Essential characteristics	Performance indicator				Penetration capacity
1. Sizes					
d x L /mm/	d /mm/	k /mm/	s /mm/	D /mm/	/mm/
4.8 x L	4.75-4.92	4.50-4.95	7.75-8	14	до 2.50
2. Material	Type steel C1022				
3. Durability	Galvanizing – 8.0 ±12.0 µm				

6. The performance of the product identified in p.1, corresponds to the declared performance in p.5.
7. The current Declaration of Performance is issued entirely under the responsibility of the company, indicated in p.3 on the basis of a declaration of the manufacturer /supplier/.

Date: 30.10.2024
Place: Plovdiv

KAM-04 Ltd.:
/ Product Manager /

