

**DECLARATION OF PERFORMANCE**

1. Description and determination of product:

**Wafer Head Nut-rivet**

2. Application:  
rivet nuts are used for connecting elements such as metal sheets, cladding, roof structures, metal profiles in systems. Requires a pre-drilling of a hole with the same diameter.

3. Name, registered trade name or registered trademark and contact address:

**KAM-04 Ltd.**

176, Brezovsko Shousse str., 4003 Plovdiv, Bulgaria

**Trade mark****kamfix**

4. System or systems for assessment and verification of constancy of performance.

System 2+

5. Declared performance indicators:

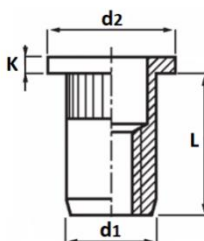
**Wafer Head Nut-rivet**

Main indicators	Performance indicator				Technical specifications
1. Sizes					
<b>M</b>	<b>L /mm/</b>	<b>d1 /mm/</b>	<b>d2 /mm/</b>	<b>K /mm/</b>	
M3	9.0	4.9	8.0	0.8	
M4	10.0	5.9	9.0	0.8	
M5	12.0	6.9	10.0	1.0	
M6	14.5	8.9	13.0	1.5	
M8	17.0	10.9	15.5	1.5	
M10	19.5	12.9	17.5	2.0	
M12	23.0	15.9	22.0	2.2	
2. Material	Steel				

6. The performance of the product identified in p.1 corresponds to the declared performance in p.5  
7. The current Declaration of Performance is issued entirely under the responsibility of the company, indicated in p.3 on the basis of a declaration of the manufacturer /supplier/.

Date: 08.09.2016

Place: Plovdiv

KAM-04 Ltd: .....

/ Product Manager /

